

2X M5X0.8 - 6H ∇ .30 [7.6]
MIRRORED ON OPPOSITE FACE

2X 1.41 [35.85]

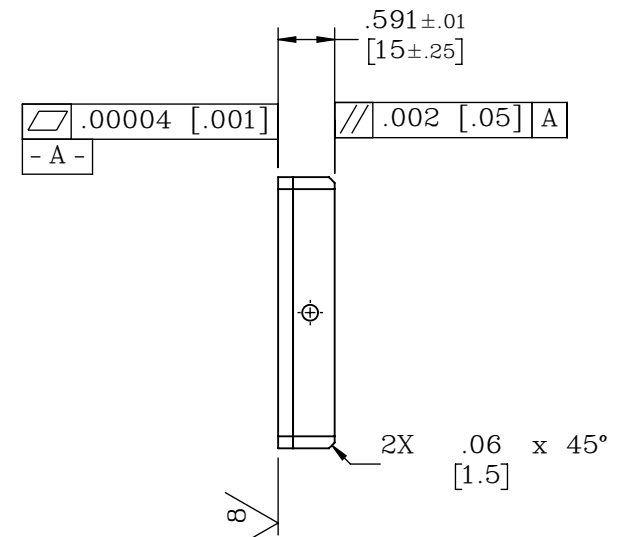
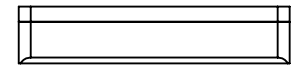
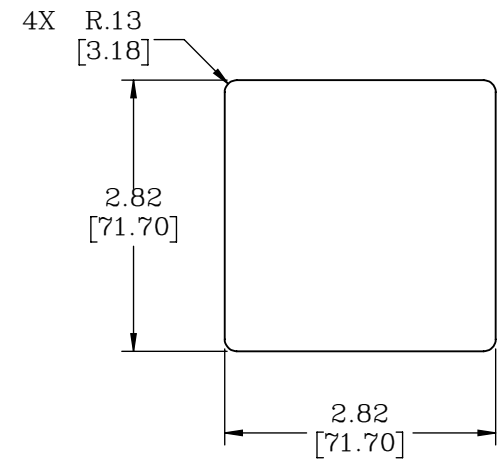
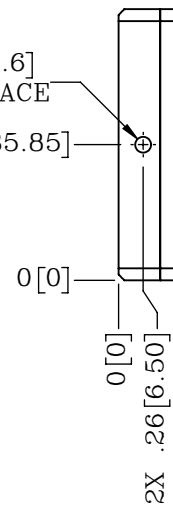

- NOTES:
1. EACH PART WILL BE SHIPPED WITH SET SCREW PLUGS.
SEAL PLUG THREADS USING LOCTITE 401 OR A COMPARABLE C.A. GLUE.
OTHER SEALING METHODS MAY PUT UNDO STRESS ON THE PART AND
AFFECT BEARING PERFORMANCE

PROPRIETARY ITEM:
THIS DRAWING CONTAINS
INFORMATION PROPRIETARY TO NEW
WAY MACHINE COMPONENTS, INC. ANY
REPRODUCTION, DISCLOSURE, OR USE
OF THIS DRAWING OR THE
INFORMATION CONTAINED HEREIN
IS EXPRESSLY PROHIBITED EXCEPT AS
NEW WAY MAY OTHERWISE AGREE TO
IN WRITING. ALL RIGHTS RESERVED BY
NEW WAY MACHINE COMPONENTS, INC.

CUSTOMER PRINT

TOLERANCES UNLESS OTHERWISE SPECIFIED		TITLE: 71.7mm X 71.7mm STANDARD BONDED BEARING		NEWWAY air bearings	
ANGLES: $\pm 1/2^\circ$		DRAWN: EJS	DATE: 06/14/16		
DECIMALS: XX \pm .01		CHECKED:	DATE:	HEAT TREAT: -	
FRACTIONS: $\pm 1/64$		SCALE: 1:2	SHT. 1 OF 1	DWG. TYPE: -	
SURFACE ROUGHNESS: \sqrt{R} RMS MAX.		USED ON (NW #): -		FINISH: BLACK ANODIZE	
BREAK ALL SHARP EDGES: .005-.020				DWG. #:	S17072115
				REV.:	A